

Technical information on drawers

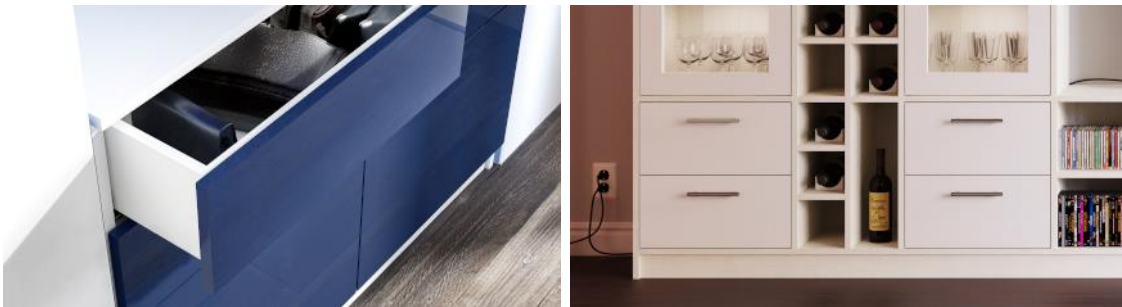

To give you great flexibility and design freedom when configuring your custom-made furniture, we offer you four different drawer options, which differ in terms of appearance and construction.

However, all drawer options have one thing in common: all drawers are equipped with a soft-close mechanism and full extension to provide you with maximum comfort. Additionally, they are fully glued and pre-assembled to make the assembly of your new piece of furniture as easy as possible.

In all configurations, a fixed shelf is automatically placed above the top drawer. You do not need to add an extra shelf during your configuration.

Drawer variants

1. Overlay front drawer:

For overlay front drawers, the drawer front overlaps the cabinet by about 2 cm. This increases the total depth of your furniture.

2. Inset front drawer:

For inset front drawers, the drawer front sits between the outer sides of the furniture.

3. Inset drawer:

Inset drawers have an opening grip about 3 cm high for easy access.

4. Drawer behind doors:

For drawers behind doors, a white plastic spacer (distance block) is integrated. This type of drawer is suitable for all overlay hinged and mirror doors, except for glass doors.



Overlay front drawer



Inset front drawer



Inset drawer



*Drawer behind doors
(see detailed images on the following page)*

In which decor are the drawers made?

For front drawers, we manufacture the drawer front to the exact millimetre in the front or body decor of your furniture. The drawer boxes are made in cream white or anthracite, depending on the body decor you select. You can see the colour of the drawer in the final configuration step in the 3D view.

Why are spacers (distance blocks) installed for drawers behind doors?

For drawers located behind hinged or sliding doors, white plastic spacers (distance blocks) are placed on the side where the door hinges are attached, to prevent any collisions between the door and the drawer behind it. The great advantage is that the drawers can be positioned freely, even next to the door hinges.



In which height and depth grids are the drawers made?

The drawers are made in modular height and depth grids. The following external dimensions are possible:

- Height grids for front drawers (external dimensions):
100 mm, 140 mm, 180 mm, 240 mm, 320 mm

- Height grids for inner drawers (external dimensions):
100 mm, 125 mm, 140 mm, 160 mm, 180 mm, 210 mm, 240 mm, 280 mm, 320 mm
The internal dimension is 20 mm smaller than the external dimension.
- The runner lengths for the depth grids are available in the following sizes:
270 mm, 300 mm, 350 mm, 400 mm, 450 mm, 500 mm, 550 mm, 600 mm, 650 mm,
and 700 mm.

Do you have any further questions or need assistance with your furniture planning? We are happy to advise you directly and personally!

Many questions can be answered easily and quickly over the phone or via email.

Phone:

+44 (0) 131 608 34 77

E-Mail:

service@furnfab.com

Furnfab.com England

Rheinische Möbelwerke GmbH
Industriestraße 2
53359 Rheinbach